

Spare parts list

Edition 080211



The control panels are renamed:

New name	Old name
Origo™ A2	A2

Spare parts are to be ordered through the nearest ESAB agency. Kindly indicate type of unit, serial number, denominations and ordering numbers according to the spare parts list.

Maintenance and repair work should be performed by an experienced person, and electrical work only by a trained electrician. Use only recommended spare parts.

Rights reserved to alter specifications without notice.

C = component designation in the circuit diagram

Item	Qty	Ordering no.	Denomination	Notes	C
	1	0458 535 881	Control panel Origo™ A2	Complete, configured for Arc 4000i	
	1	0458 535 889	Control panel Origo™ A2	Complete, configured for Arc 5000i	
JA1	4	0458 544 001	Insulation nut		
JA2	1	0458 538 001	Screening box		
JA3	1	0486 819 887	Circuit board	The circuit board must be configured when installed	1AP1
JA4	1		Connector	9 pole, D-sub. See the spare parts list for the power source	
JA5	1	0193 052 981	Screw		
JA6	1	0458 381 001	Seal		
JA7	1	0458 540 001	Indicating lamp	LED	D1
JA8	1	0321 475 882	Knob		
JA9	1	0321 475 881	Knob		
JA10	1	0458 539 001	Operating panel	A2 for Arc 4000i	
JA10	1	0458 539 009	Operating panel	A2 for Arc 5000i	
JA11	2	0191 870 616	Potentiometer	10kΩ 2W	R1, R2
JA12	4	0394 516 003	Spacer screw	L = 10mm	
JA13	4	0458 537 001	Spacer screw	L = 17mm	

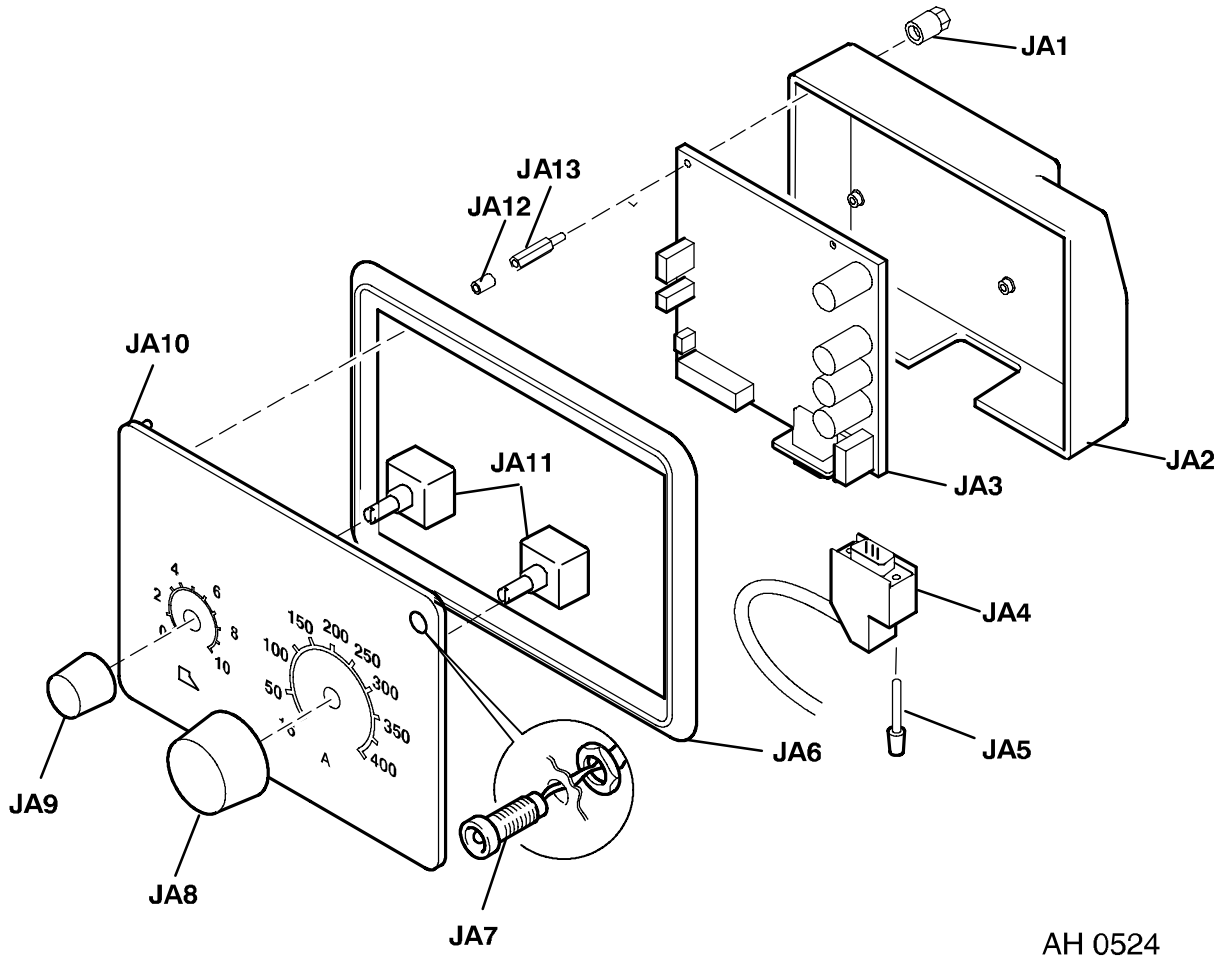

AH 0524